

LIGHT RADIAL DRILLING MACHINE GUARDS - LRTS & LRTL - SIDE OPENING

- Machine Type - Light/ Radial type
- Method of attachment - Secures around depth stop collar using fixing top to suit configuration
- Positive Manual latch
- Side opening
- Construction - Aluminum with Polycarbonate Vizard encloses the work area
- Operation - Telescopes on contact with work piece length adjustable vizor
- Can be extended to 350mm by adding third section. Model LRTLL



LRTS/2



LRTL/2



TECHNICAL DATA:

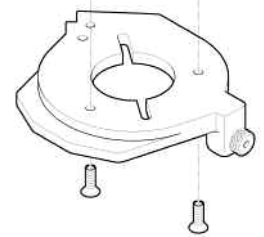

GUARD TOP No 1

This is for fitting under the Bearing Housing and can take the place of the dust cover plate. Where quill retracts into the Head it is fitted by drilling and tapping the underneath side of the head and bolted by means of countersunk screws to the machine.

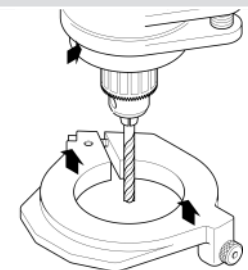

GUARD TOP No 2

This is an integral clamp which can be bored out to suit any non-rotating collar size from 47 to 101mm. On some drilling machines it may be necessary to raise the stop-gauge castings to expose this collar.

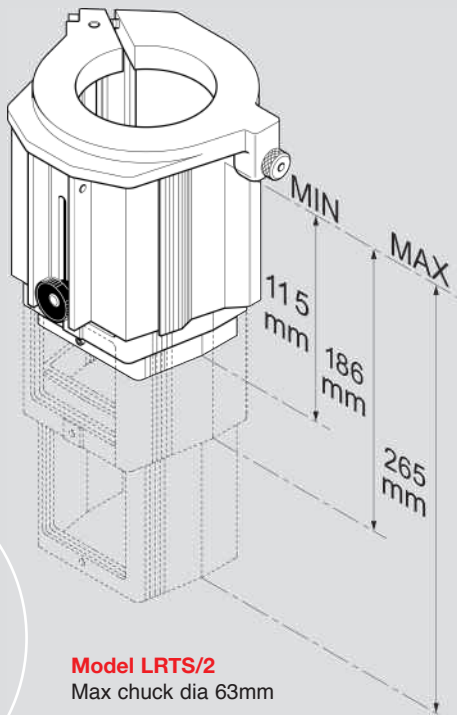

Model LRTS/2
Max chuck dia 63mm

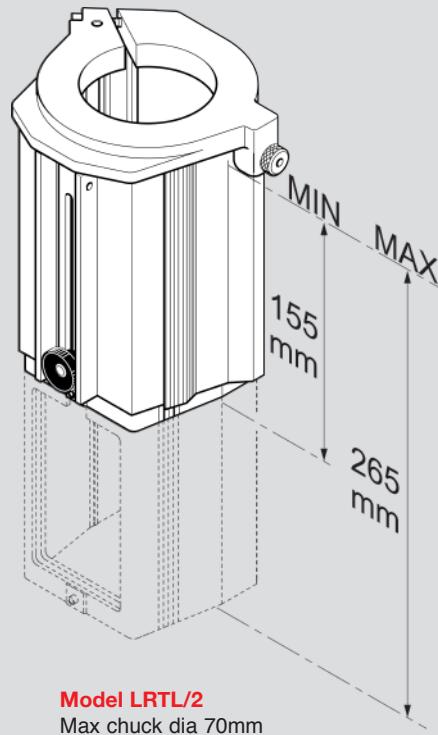

Model LRTL/2
Max chuck dia 70mm